

Centering Line Coll

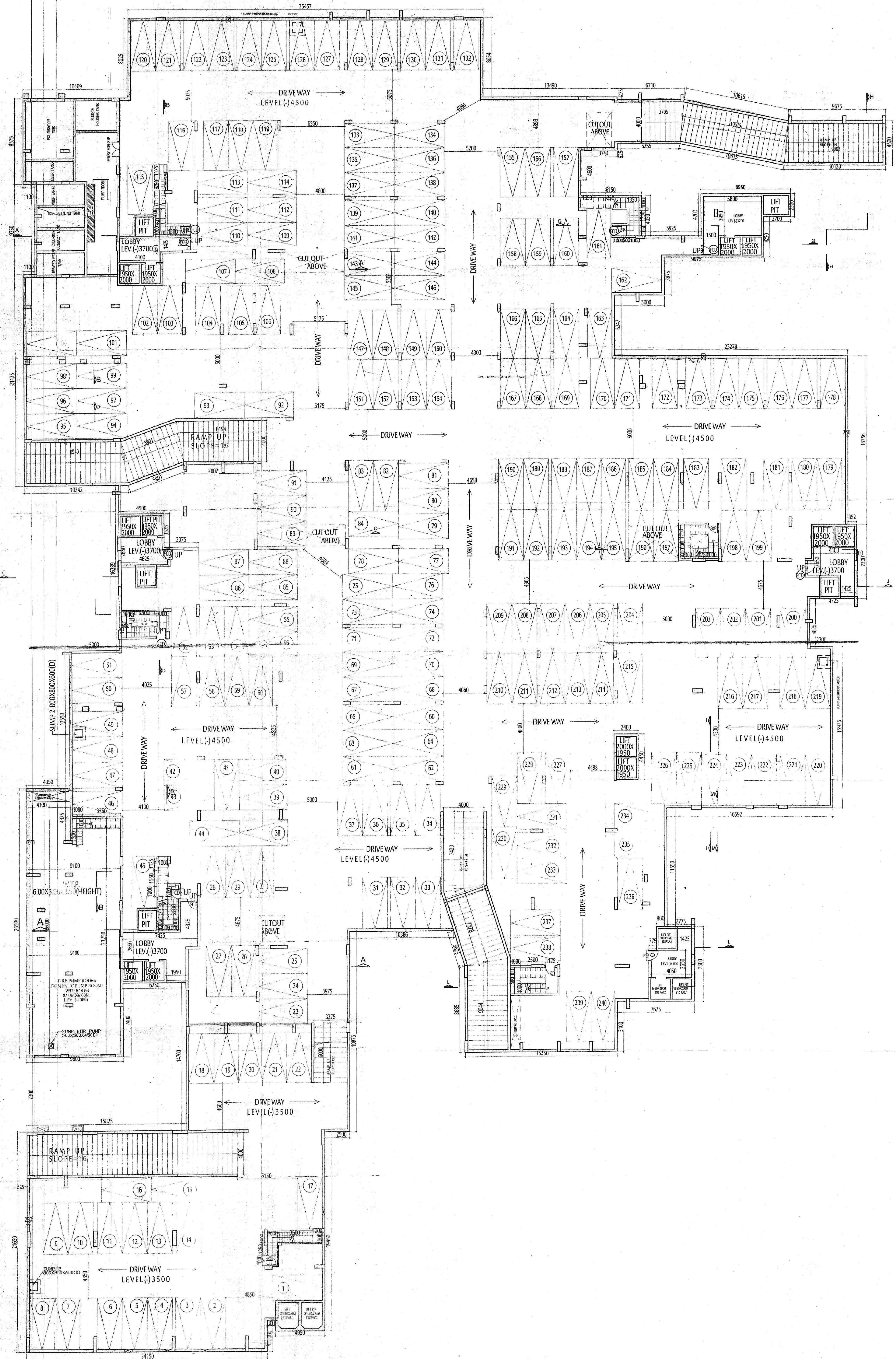

- GENERAL NOTES**
1. ALL DIMENSIONS ARE IN MM.
 2. ALL EXTERNAL WALLS 250TH. & 200TH. & INTERNAL WALLS 125 & 75 THK. UNLESS OTHERWISE MENTIONED.
 3. ALL MASONRY WORKS ARE BOUNDED BY CEMENT MORTAR (1:6) & (1:4).
 4. EXTERNAL PLASTER IS 25TH. & INTERNAL PLASTER IS 12MM. TH WITH 1:4 MORTAR.
 5. ALL CONC. GRADE IS M20 (1:1.5:3).

COMPANY NAME
ARCHITRA PROPERTIES PRIVATE LIMITED & OTHERS

For Arch Infra Properties Private Limited
Rajendra Kumar Sanyal
Authorized Signatory

SIGNATURE OF OWNER

CERTIFICATE OF STRUCTURAL ENGINEER
CERTIFIED THAT, "THE STRUCTURAL DESIGN & DRAWINGS OF BOTH FOUNDATION & SUPER STRUCTURE OF THE BUILDING HAS BEEN MADE BY ME CONSIDERING ALL POSSIBLE LOADS INCLUDING THE SEISMIC LOAD AS PER THE NATIONAL BUILDING CODE OF INDIA & CERTIFIED THAT IT IS SAFE & STABLE IN ALL RESPECTS".

SANJIV J. PAREKH
SANJIV J. PAREKH
REGISTERED CIVIL ENGINEER
REG. NO. 104 (I) K. M. C.

SANJIV GUHA
SANJIV GUHA
REGISTERED CIVIL ENGINEER
REG. NO. 104 (I) K. M. C.

SIGNATURE OF STRUCTURAL ENGINEER

CERTIFICATE OF ARCHITECT
THE L.B.A. HAS CERTIFIED ON THE PLAN ITSELF WITH FULL RESPONSIBILITY THAT THE BUILDING PLAN HAS BEEN DRAWN UP AS PER PROVISION OF W.B.M. BLDG. RULES 2007, AS AMENDED FROM TIME TO TIME AND THAT THE SITE CONDITION INCLUDING THE WIDTH OF THE ADJUTING ROAD CONFIRM WITH THE PLAN AND IT IS A BUILDABLE SITE AND NOT A TANK OR A FILLED UP TANK.

Rajkumar Agarwal
Rajkumar Agarwal
Architect
Member of Council of Architecture CA / 91 / 17940

SUDIP SARKAR
SUDIP SARKAR
REGISTERED CIVIL ENGINEER
REG. NO. 104 (I) K. M. C.

SIGNATURE OF ARCHITECT

TITLE
BASEMENT PLAN

DATE	JOB NO.	DEALT	CHECKED	SHEET NO.
03.02.14	ARCH/332/2010	TUMPA		1 OF 13

PROJECT
REVISED PLAN OF TOWER-8 (B+G+X) STORED (33.3 M. HEIGHT) COMMERCIAL BUILDING & TOWER (1,2,3,4,5) (B+G+X) STORED (33.3 M. HEIGHT) AND TOWER (6&7) (B+G+X) STORED (33.9 M. HEIGHT) RESIDENTIAL HOUSING COMPLEX AT DAG NO-534 OF MOUZA TEGHORIA DAG NO-139,140,143 & 144 OF MOUZA ATGHARAL.R. KHATAN NO-1654,1643,1662,1639,1653,1640,707,707,1642,1645,1637,1663,1666,1656,1663,1650,1657,1637,1646,827/653/1650,2072,1657,1646,1651,1654,1666,1649,1644,470,1653,1675,1662,707,1651,781/1 & 782/2,1658,55,1689/1765,1639,1643,1649,1640,1658.P5-BAGUHATI, I, NO-9 & 10, WARD NO-9, UNDER RAJARHAT GOPALPUR MUNICIPALITY DISTRICT-(N) 24 PARGANAS WIDE SANCTION PLAN NO. 1341/14/15 DATED: 08/10/15

SCALE
1:150

ARCHITECT
RAJ AGRAWAL & ASSOCIATES
88, ROYD STREET,
KOLKATA 700 016

(1)

SPARE COPY
Certified True Copy

RENEWED
UP To 03/10/2020

5.10.20
Executive Engineer
Building Plan
Bidhanagar Municipal Corporation

APPROVED
Bidhanagar Municipal Corporation
Planning & Building Department
Date: 03/10/2020
N.C.NC/ASH/RG/AG/ASHA/AA-15R (1/13)
Date: 03/10/2020
Date: 03/10/2020

CHECKED BY
Assistant Engineer
Bidhanagar Municipal Corporation

- Approved Subject to:
- 1) Building rules for Bidhanagar Municipal Corporation shall have to be observed, carefully.
 - 2) No wastage of water shall be made, check valve must be provided in groundwater ground & overhead reservoir.
 - 3) In no case water from rain water pipe and the surface drainage should be connected to the house sewer directly or through any yard gully.
 - 4) Plan showing internal sewer system and water supply lines have got to be separately sanctioned.
 - 5) Before starting any construction it should be satisfied that the site dimension conforms with that of plans sanctioned and all the conditions as provided in the plan shall be fulfilled.
 - 6) Plans and drawings shall not be changed by changing of building materials like of masonry etc. without prior permission.
 - 7) Prior to commencement of construction Appendix B drawings to be submitted.

During construction following measures shall be taken to reduce the effects of dust & noise from building construction site:

- Properly covering all building materials stacked outside the site - bags, sand, lime & stone chips.
- Using water sprays or sprinklers to keep dust down during activities such as concreting, plastering, bricklaying etc. and during loading & unloading.
- Washing the wheels of vehicles leaving the site if they are loaded with mud or waste.
- Putting up solid barriers around the site.
- Properly covering trucks & vehicles loaded with materials to prevent dispersing building materials and building dust.
- Cleaning and wetting the road & ground adjacent to the site at frequent intervals.
- Using dust bags, avoiding under wind blowing strong winds and making the working area wet before using the machinery.
- Not burning waste material at site which causes smoke containing carbon monoxide and a range of toxicous substances.

REVALIDATED
UP To 03/10/2025

9.6.22
Executive Engineer
Building Plan
Bidhanagar Municipal Corporation

Assistant Engineer
Bidhanagar Municipal Corporation